



the **ATRIUM**
at gillette ridge

1300 HALL BOULEVARD | BLOOMFIELD, CT

- AMENITY-RICH THREE-BUILDING CAMPUS
- OFFICE/WAREHOUSE/FLEX OPPORTUNITY IN HARTFORD COUNTY



SPACE DETAILS



OFFICE

- The best large blocks of quality space in Hartford County
- Up to 259,000 SF vacant
- Plug-and-play space available with furniture in-place
- Mostly open design
- Signage opportunities



WAREHOUSE

- 18' clear heights
- Stand-alone identity
- 6 docks
- Attached to main office building which offers extensive amenities



FLEX

- Very high ceilings
- Abundant parking
- Ideal space for high-tech, back office, non-profit, educational use, light assembly
- Attached to main office building which offers extensive amenities
- Great stand-alone identity

Possession: Immediate

Term: Negotiable – 5 to 10 years (typical)

Asking Rent:

- Office: \$22.00 full service gross
- Warehouse: TBD
- Flex: TBD



BUILDING FEATURES

CLASS A OFFICE BUILDING FEATURING THE BEST AMENITIES IN HARTFORD COUNTY

-  • Food service and coffee bar
- Conference Center
-  • Fitness Center with Lockers/Showers
- Raised Floor
-  • High Ceilings
- Structured Parking
-  • Huge Windows
- 50 Acre Campus
-  • Adjacent Arnold Palmer-Designed Championship Golf Course
- Outdoor Patios
-  • Bus Stop On-site
-  • On-site Security
- Glass Elevators
-  • Indoor Waterfall
- 4-story Glass Atrium
-  • Back-up Power
- White Noise System



NEW Outdoor Fire Pits



NEW Game Room



NEW Indoor Golf Simulator



NEW EV Charging Stations



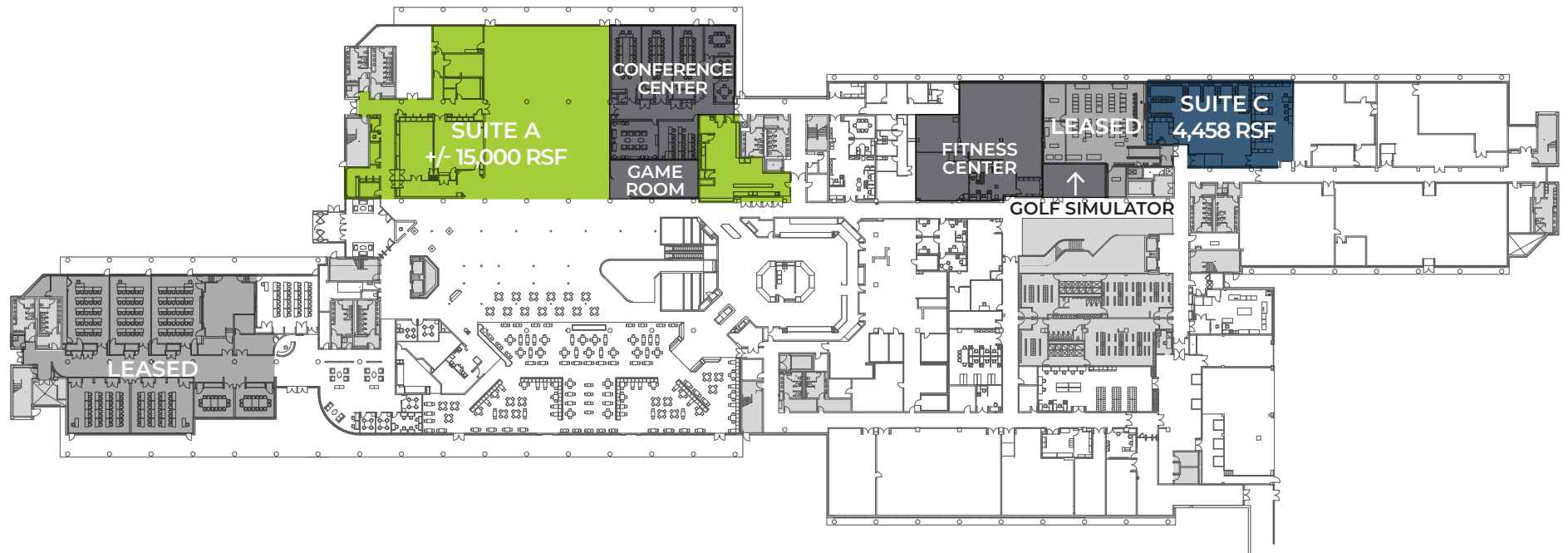

JOEL M. GRIECO

Direct: +1 860 616 1443

Mobile: +1 860 593 2078

joel.grieco@cushwake.com

TIMOTHY D'ADDABBO

Direct: +1 860 616 1434

Office: +1 860 249 0900

timothy.daddabbo@cushwake.com

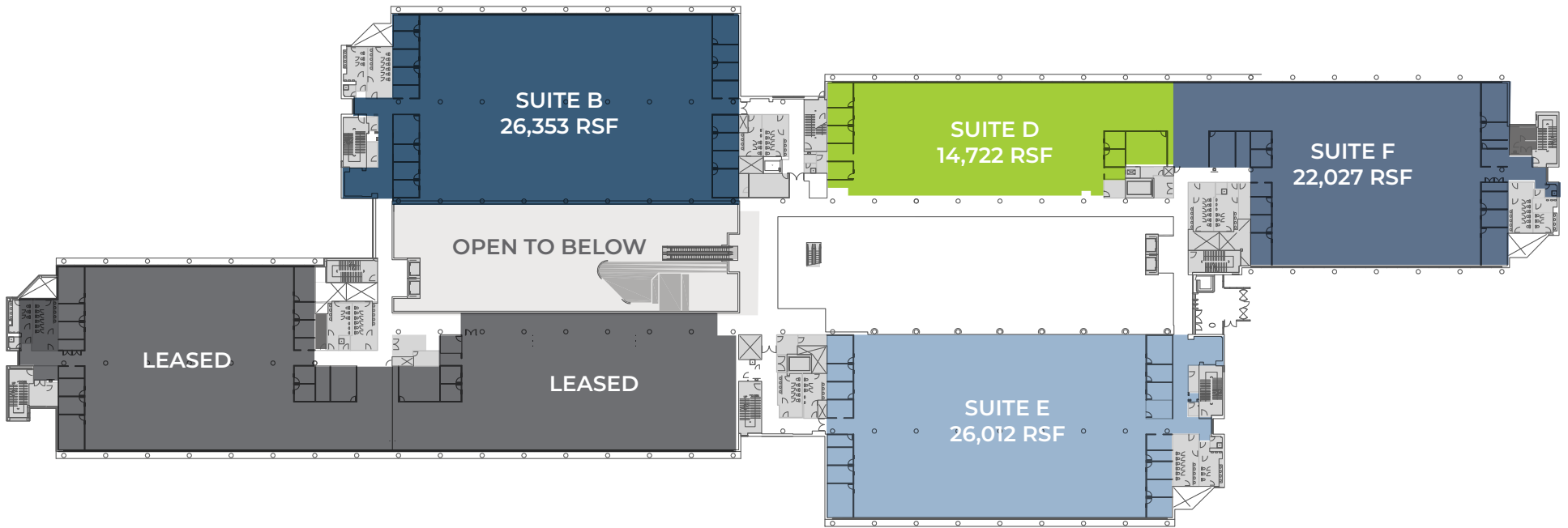

JOEL M. GRIECO

Direct: +1 860 616 1443
 Mobile: +1 860 593 2078
joel.grieco@cushwake.com

TIMOTHY D'ADDABBO

Direct: +1 860 616 1434
 Office: +1 860 249 0900
timothy.daddabbo@cushwake.com

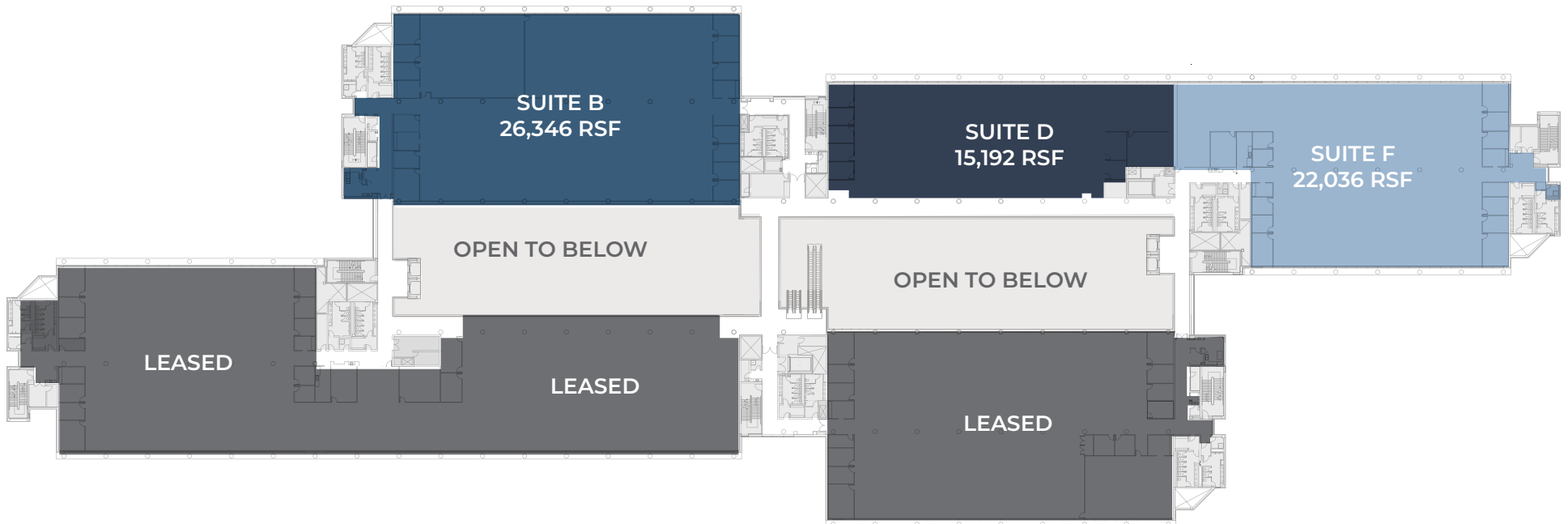

JOEL M. GRIECO

Direct: +1 860 616 1443
Mobile: +1 860 593 2078
joel.grieco@cushwake.com

TIMOTHY D'ADDABBO

Direct: +1 860 616 1434
Office: +1 860 249 0900
timothy.daddabbo@cushwake.com



JOEL M. GRIECO

Direct: +1 860 616 1443
Mobile: +1 860 593 2078
joel.grieco@cushwake.com

TIMOTHY D'ADDABBO

Direct: +1 860 616 1434
Office: +1 860 249 0900
timothy.daddabbo@cushwake.com

LOCATION



Strategically located in central Connecticut just eight minutes from downtown Hartford, 20 minutes from Bradley International Airport, and 5 minutes to West Hartford Center, The Atrium offers a rural campus setting with convenient city access.





the **ATRIUM**
at gillette ridge

1300 HALL BOULEVARD | BLOOMFIELD, CT

FOR INFORMATION, PLEASE CONTACT:

JOEL M. GRIECO

Direct: +1 860 616 1443

Mobile: +1 860 593 2078

joel.grieco@cushwake.com

TIMOTHY D'ADDABBO

Direct: +1 860 616 1434

Office: +1 860 249 0900

timothy.daddabbo@cushwake.com

©2023 Cushman & Wakefield. All rights reserved. The information contained in this communication is strictly confidential. This information has been obtained from sources believed to be reliable but has not been verified. NO WARRANTY OR REPRESENTATION, EXPRESS OR IMPLIED, IS MADE AS TO THE CONDITION OF THE PROPERTY (OR PROPERTIES) REFERENCED HEREIN OR AS TO THE ACCURACY OR COMPLETENESS OF THE INFORMATION CONTAINED HEREIN, AND SAME IS SUBMITTED SUBJECT TO ERRORS, OMISSIONS, CHANGE OF PRICE, RENTAL OR OTHER CONDITIONS, WITHDRAWAL WITHOUT NOTICE, AND TO ANY SPECIAL LISTING CONDITIONS IMPOSED BY THE PROPERTY OWNER(S). ANY PROJECTIONS, OPINIONS OR ESTIMATES ARE SUBJECT TO UNCERTAINTY AND DO NOT SIGNIFY CURRENT OR FUTURE PROPERTY PERFORMANCE.

