



JOEL M. GRIECO

Direct: +1 860 616 1443
 Mobile: +1 860 593 2078
 joel.grieco@cushwake.com

TIMOTHY D'ADDABBO

Direct: +1 860 616 1434
 Office: +1 860 249 0900
 timothy.daddabbo@cushwake.com

THIRD FLOOR

SUITE A - 19,170 RSF

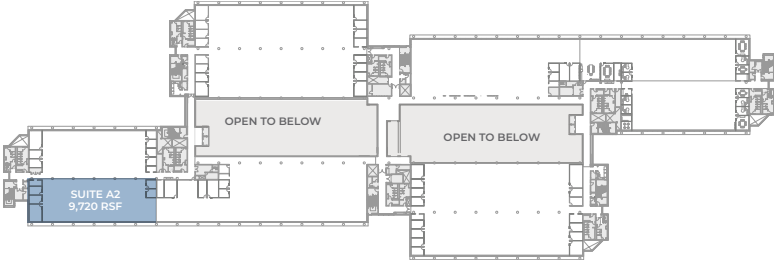

1300 HALL BOULEVARD
BLOOMFIELD, CT

JOEL M. GRIECO
+1 860 616 1443
joel.grieco@cushwake.com

TIMOTHY D'ADDABBO
+1 860 616 1434
timothy.daddabbo@cushwake.com



THIRD FLOOR

SUITE C - 20,837 RSF



1300 HALL BOULEVARD
BLOOMFIELD, CT

JOEL M. GRIECO
+1 860 616 1443
joel.grieco@cushwake.com

TIMOTHY D'ADDABBO
+1 860 616 1434
timothy.daddabbo@cushwake.com



THIRD FLOOR

SUITE E - 26,723 RSF

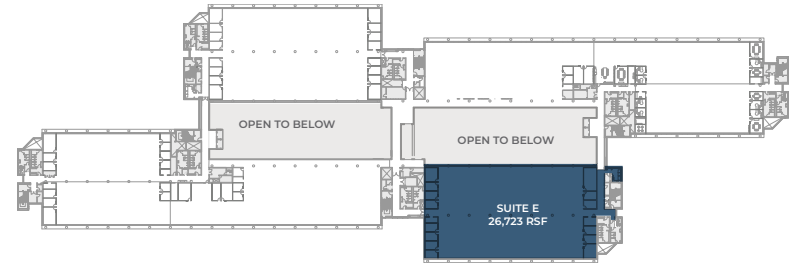

1300 HALL BOULEVARD
BLOOMFIELD, CT

JOEL M. GRIECO
+1 860 616 1443
joel.grieco@cushwake.com

TIMOTHY D'ADDABBO
+1 860 616 1434
timothy.daddabbo@cushwake.com



THIRD FLOOR

SUITE F2 - 10,564 RSF

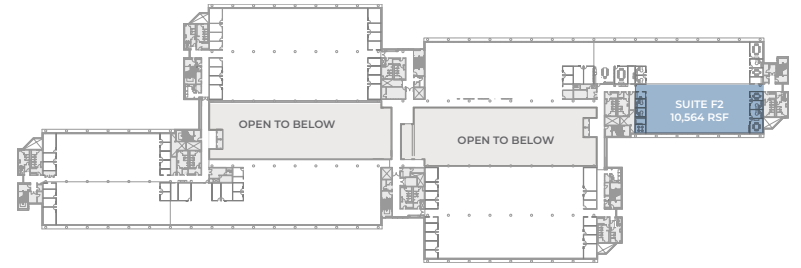

1300 HALL BOULEVARD
BLOOMFIELD, CT

JOEL M. GRIECO
+1 860 616 1443
joel.grieco@cushwake.com

TIMOTHY D'ADDABBO
+1 860 616 1434
timothy.daddabbo@cushwake.com



CONTIGUOUS THIRD FLOOR

SUITES A, C, & E - 57,280 RSF

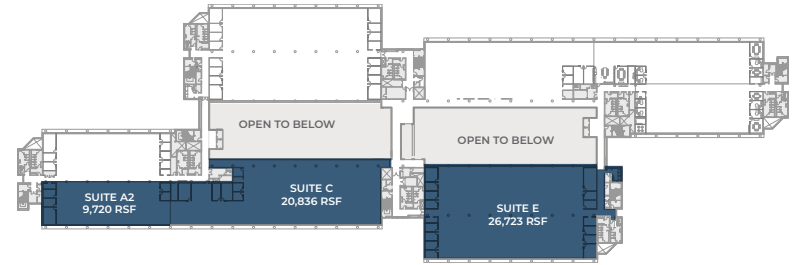

1300 HALL BOULEVARD
BLOOMFIELD, CT

JOEL M. GRIECO
+1 860 616 1443
joel.grieco@cushwake.com

TIMOTHY D'ADDABBO
+1 860 616 1434
timothy.daddabbo@cushwake.com

